



uvex

EQUESTRIAN

wherever
you ride





Ingrid Klimke
Helmet uvex suxseed diamond
Gloves uvex sumair

uvex

protecting people since 1926

Professional or recreational. Competition or fun. Based in Fürth, Germany, uvex is one of the leading international manufacturers of personal protective equipment and has been inspiring customers with pioneering technologies and innovative products for 95 years. Whether it's leisure, sport, or work, uvex products help you to achieve your best. uvex – protecting people since 1926.

index

8–13

highlights

14–37

riding helmets

38–47

riding gloves

48–53

eyewear

54–55

accessories //
merchandise

56–57

tech
summary

proudly protected by uvex

Protecting people is our mission, our responsibility – but also our passion. We are proud of the performance of our professional athletes, whom we support and protect with a maximum of safety, in competition or leisure time activities.

wherever
you ride

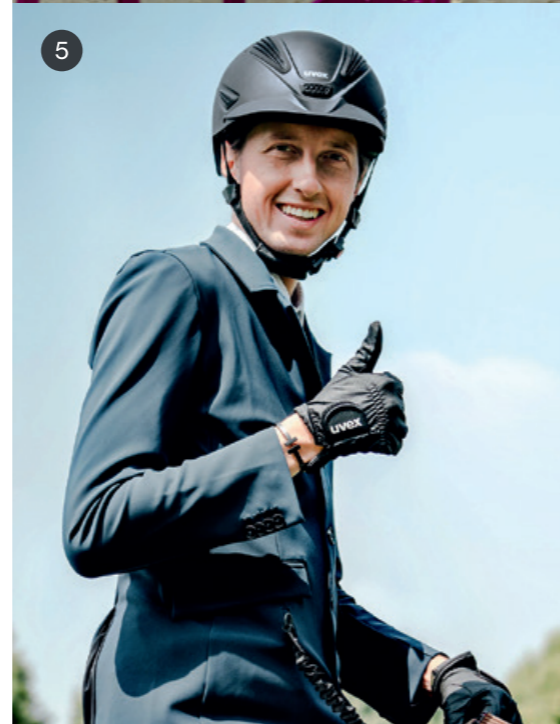

athletes

1 Hans-Dieter Dreher
Show jumping

2 Ingrid Klimke
Eventing
Show jumping
Dressage

3 Greta Reinacher
Show jumping

4 Jennifer Fogh Pedersen
Show jumping

5 Martin Fuchs
Show jumping

6 Ellen Richter
Dressage

7 Marc Houtzager
Show jumping

wherever you ride

A uvex riding helmet is the perfect headgear for dressage, show jumping, or cross-country. Training, eventing, or leisurely hacking. Whether you opt for a traditional or more fashionable style, every uvex riding helmet offers a high-quality superior ventilation, and, of course, unbeatable safety.

For exceptional protection – 24/7, 365 days of the year – uvex is the go-to choice. Wherever you ride.



Hans-Dieter Dreher
Helmet uvex perfoxion II





uvex exxential II LED

The innovative uvex exxential II LED is the perfect companion on every road. From dawn to dusk and beyond. Invisible during the day, the integrated helmet lighting can be activated at any time at the push of a button.



uvex exxential II MIPS

When falling, the human brain can be exposed to strong rotational movements due to an oblique impact. The innovative height-adjustable MIPS (Multi-Directional Impact Protection System) cage – built into a uvex riding helmet for the first time ever – offers extensive protection.



uvex elexxion Tocsen

The revolutionary Tocsen sensor stores movement patterns and detects a fall from a horse with the highest precision. If the rider does not confirm that they are unharmed, an emergency call with the GPS data of the scene of the accident is automatically sent.



highlights

uvex technologies

Whether for increased visibility, innovative and improved protection or a smart rescue system: uvex has integrated three new technologies into its riding helmets, taking the next step towards even higher safety in equestrian sports.

The uvex exxential II LED ensures optimal visibility in the forest and on country roads, especially in conditions like fog or early dusk. The uvex exxential II MIPS, which is identical in construction, has a safety system thanks to the integrated MIPS layer that absorbs dangerous rotational energy in the event of a fall. And the uvex elexxion Tocsen can save lives: it calls for help after a fall. The new uvex helmets not only impress with their integrated technology, but also with their design. Feeling safe has never looked more stylish.



An all-rounder

The uvex exxential II LED can do everything: the new helmet meets both the riding and cycling helmet standards. This means that riders who cycle to the stable are always perfectly protected.

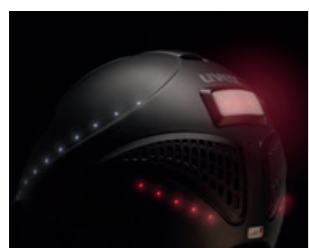

31 LED Spots

The integrated LED spots, white on the sides and red on the back, showcase optimized visibility on busy roads and a high level of protection in traffic.



Smart and rechargeable

Thanks to the innovative magnetic adhesion system, the battery can be easily attached. Depending on use and lighting mode, the battery lasts between 6 and 12 hours.

highlights

uvex exxential II LED

The new uvex exxential II LED not only looks really good – it is a true eyecatcher. On the morning round or while riding in the twilight, past country roads or on busy streets. The new, sporty all-rounder is the first uvex riding helmet with innovative helmet lighting and the spoga horse TOP INNOVATIONS winner of 2021. An astounding number of 31 LED spots – integrated directly into the helmet – ensures extremely good visibility in the dark.

The lights are activated with just one push of a button and can easily be operated in three different lighting modes: constant, flashing or pulsing. The plug-in LED serves as an additional rear light on the back of the head – for more visibility even on horseback.

MADE IN
GERMANY





Tocsen Button

The Tocsen precision crash sensor fits perfectly on any helmet. The button can be attached quickly and easily behind the ear on the hard shell of the helmet and is immediately ready to use.



Tocsen helmet

Now available: the new uvex elexxion Tocsen riding helmet with the integrated Tocsen sensor and spoga horse TOP INNOVATIONS winner of 2021.



Tocsen App

Available for free, easy to use – and a strong, growing community as a backbone.



highlights



TOCSEN

Calls if you fall

Even if unaccompanied rides mean freedom – in an emergency, we need help from other people as soon as possible. With the revolutionary uvex Tocsen technology, there is now an additional partner, who, thanks to a precision sensor, can reliably detect falls and save lives.

If the sensor has registered a fall and does not receive any direct feedback from the rider, Tocsen automatically sends an emergency call including GPS data. Because professional help isn't always nearby, the system also feeds the emergency call into the constantly growing Tocsen community. Potential rescuers are informed via app and can go directly to the scene of the accident to provide first aid.



uvex elexxion pro



The uvex elexxion pro hybrid helmet is a real eye-catcher, wherever you ride. Dirt track or homestretch. High-quality detailing in matt, gloss, and chrome completes the classy design. The 3D IAS system guarantees a perfect fit on every head. The ventilation system is also adjustable, providing a cooling flow of air even on hotter days. Blue, brown or classic in black – the uvex elexxion pro makes a real statement. Made in Germany.



features



Ventilation system with chrome detailing

The ventilation system is individually adjustable to ensure optimal climate management, while the chrome detailing adds that extra wow factor.



Increased durability

The unique wrap-around EPS shell protects the edges of the helmet for increased durability, which means this helmet will look great for longer.

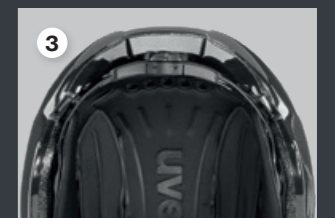

Slim fit inner lining

The removable and washable slim fit interior pads ensure the best possible comfort, while the height and width adjustable 3D IAS system ensures a perfect fit on every head.

uvex suxceed diamond lady new

Elegant riding helmet: perfect for training or competition

Embellished with high-quality Swarovski® crystals and an extravagant artificial satin cover

With an extra-wide visor that protects against the sun: ideal for the green season

MADE IN GERMANY



Features

- Hardshell technology
- Lady shield
- 2 shell sizes
- Monomatic fastener
- R-FAS strap
- 3D IAS fit system
- Suitable for spectacle wearers
- Excellent ventilation
- Strap covers in high-quality synthetic leather
- Chrome-plated frame
- Satin helmet cover
- Top with Swarovski® crystals
- Weight from 520 g
- Standards: EN 1384:2012 + VG1 01.040 2014-12



uvex suxceed diamond new

The bestseller uvex suxceed diamond shines with a multitude of Swarovski® crystals – like a starry night sky

Outstanding fit and individual adjustment in height and width

MADE IN GERMANY



Features

- Hardshell technology
- Glossy piano lacquer frame
- 2 shell sizes
- Monomatic fastener
- R-FAS strap
- 3D IAS fit system
- Suitable for spectacle wearers
- Excellent ventilation
- Strap covers in high-quality synthetic leather
- Satin helmet cover
- Top with Swarovski® crystals
- Weight from 510 g
- Standards: EN 1384:2012 + VG1 01.040 2014-12



Jennifer Fogh Pedersen

new



black

S43.6.495.0104 // xs-s
S43.6.495.0105 // s
S43.6.495.0106 // m-l



black

S43.6.476.0104 // xs-s
S43.6.476.0105 // s
S43.6.476.0106 // m-l



navy

S43.6.476.0504 // xs-s
S43.6.476.0505 // s
S43.6.476.0506 // m-l

new



navy-rosé

S43.6.476.0604 // xs-s
S43.6.476.0605 // s
S43.6.476.0606 // m-l

uvex suxceed glamour

Part of the successful uvex suxceed helmet series

Showcasing precious Swarovski® crystals within the frame and a sparkling glitter insert

Individual adjustment in height and width

MADE IN GERMANY

Features

- Hardshell technology
- 2 shell sizes
- 3D IAS fit system
- Monomatic fastener
- R-FAS strap
- Strap covers in high-quality synthetic leather
- Alcantara helmet cover
- Excellent ventilation
- Suitable for spectacle wearers
- Frame with Swarovski® crystals
- Weight from 510 g
- Standards: EN 1384:2012 + VG1 01.040 2014-12



uvex suxceed starshine

Part of the successful uvex suxceed helmet series

Showcasing precious Swarovski® crystals within the frame and a sparkling glitter insert

Individual adjustment in height and width

MADE IN GERMANY

Features

- Hardshell technology
- Glossy piano lacquer frame
- 2 shell sizes
- 3D IAS fit system
- Monomatic fastener
- R-FAS strap
- Strap covers in high-quality synthetic leather
- Excellent ventilation
- Suitable for spectacle wearers
- Frame with Swarovski® crystals
- Weight from 510 g
- Standards: EN 1384:2012 + VG1 01.040 2014-12



black

S43.6.472.0104 // xs-s
S43.6.472.0105 // s
S43.6.472.0106 // m-l



blue

S43.6.472.0304 // xs-s
S43.6.472.0305 // s
S43.6.472.0306 // m-l



black

S43.6.477.0104 // xs-s
S43.6.477.0105 // s
S43.6.477.0106 // m-l



navy

S43.6.477.0304 // xs-s
S43.6.477.0305 // s
S43.6.477.0306 // m-l



navy-champagner

S43.6.477.0604 // xs-s
S43.6.477.0605 // s
S43.6.477.0606 // m-l

uvex suxceed chrome

Part of the successful uvex suxceed helmet series

The combination of the shiny chrome frame with optimal ventilation and a matt helmet finish is a real eye-catcher

Individual adjustment in height and width

MADE IN GERMANY

Features

- Hardshell technology
- 2 shell sizes
- 3D IAS fit system
- Monomatic fastener
- R-FAS strap
- Strap covers in high-quality synthetic leather
- Excellent ventilation
- Chrome-plated ventilation system
- Suitable for spectacle wearers
- Weight from 510 g
- Standards: EN 1384:2012 + VG1 01.040 2014-12



uvex suxceed active

Part of the successful uvex suxceed helmet series

The elegant yet robust hard-shell helmet impresses with its particularly effective climate management and a high level of comfort

Individual adjustment in height and width

MADE IN GERMANY

Features

- Hardshell technology
- Glossy piano lacquer frame
- 2 shell sizes
- 3D IAS fit system
- Monomatic fastener
- R-FAS strap
- Strap covers in high-quality synthetic leather
- Excellent ventilation
- Suitable for spectacle wearers
- Weight from 510 g
- Standards: EN 1384:2012 + VG1 01.040 2014-12



black mat-silver

S43.6.479.0104 // xs-s
S43.6.479.0105 // s
S43.6.479.0106 // m-l



black mat-metal black

S43.6.479.0204 // xs-s
S43.6.479.0205 // s
S43.6.479.0206 // m-l



navy mat-coral

S43.6.479.0404 // xs-s
S43.6.479.0405 // s
S43.6.479.0406 // m-l



black mat

S43.6.470.0104 // xs-s
S43.6.470.0105 // s
S43.6.470.0106 // m-l



navy mat

S43.6.470.0504 // xs-s
S43.6.470.0505 // s
S43.6.470.0506 // m-l

uvex perfexxion II grace new

The lower neck shell ensures maximum safety
 Shines with 38 Swarovski® crystals
 The ponytail cut-out provides a comfortable fit
 Optimum climate management thanks to the chrome-plated pentagon dynamic ventilation system



Features

- Hardshell technology
- 3D IAS fit system
- Monomatic fastener
- FAS fit system
- 3 shell sizes
- Excellent ventilation
- Suitable for spectacle wearers
- 38 Swarovski® crystals in the forehead area
- High-quality synthetic leather webbing covers and piping
- Chrome-plated ventilation system
- Weight from 480 g
- Standards: EN 1384:2012 + VG1 01.040 2014-12



uvex perfexxion II

The lower neck shell ensures maximum safety
 The ponytail cut-out provides a comfortable fit
 Optimum climate management thanks to the pentagon dynamic ventilation system



Features

- Hardshell technology
- 3D IAS fit system
- Monomatic fastener
- FAS fit system
- 3 shell sizes
- Excellent ventilation
- Suitable for spectacle wearers
- Weight from 480 g
- Standards: EN 1384:2012 + VG1 01.040 2014-12



Kristina Bröring-Sprehe

new



black mat

S43.6.483.0103 // xxs-s
 S43.6.483.0105 // s-m
 S43.6.483.0106 // m-l

new



burgundy

S43.6.483.0603 // xxs-s
 S43.6.483.0605 // s-m
 S43.6.483.0606 // m-l



black mat

S43.6.480.0103 // xxs-s
 S43.6.480.0104 // xs-s
 S43.6.480.0105 // s-m
 S43.6.480.0106 // m-l
 S43.6.480.0107 // l-xl



brown mat

S43.6.480.0203 // xxs-s
 S43.6.480.0204 // xs-s
 S43.6.480.0205 // s-m
 S43.6.480.0206 // m-l
 S43.6.480.0207 // l-xl



blue mat

S43.6.480.0303 // xxs-s
 S43.6.480.0304 // xs-s
 S43.6.480.0305 // s-m
 S43.6.480.0306 // m-l
 S43.6.480.0307 // l-xl



anthracite mat

S43.6.480.0403 // xxs-s
 S43.6.480.0404 // xs-s
 S43.6.480.0405 // s-m
 S43.6.480.0406 // m-l
 S43.6.480.0407 // l-xl



sand mat

S43.6.480.0503 // xxs-s
 S43.6.480.0504 // xs-s
 S43.6.480.0505 // s-m
 S43.6.480.0506 // m-l
 S43.6.480.0507 // l-xl

uvex elexxion pro

The innovative hybrid riding helmet combines hard-shell and inmould technology

Elegant design with a unique matt-glossy look

Individual adjustment in height and width

MADE IN GERMANY

Features

- Hybrid technology
- Double inmould technology
- 2 shell sizes
- 3D IAS fit system
- Monomatic fastener
- FAS Strap
- Excellent adjustable ventilation
- Changeable lining
- Slim fit lining (optional)
- Suitable for spectacle wearers
- Chrome-plated slider
- Weight from 470 g
- Standards: EN 1384:2012 + VG1 01.040 2014-12



uvex elexxion Tocsen new

With integrated Tocsen fall sensor and automatic emergency call system

spoga horse TOP INNOVATIONS winner 2021

Elegant, robust helmet with a unique look

Individual adjustment in height and width

MADE IN GERMANY



Features

- Tocsen Crash Sensor
- Hybrid technology
- Inmould technology
- 2 shell sizes
- Anatomic IAS fit system
- Monomatic fastener
- FAS Strap
- Excellent adjustable ventilation
- Changeable lining
- Slim fit lining (optional)
- Suitable for spectacle wearers
- Weight from 470 g
- Standards: EN 1384:2012 + VG1 01.040 2014-12



blue mat shiny

S43.3.435.0304 // xs-s
S43.3.435.0305 // s
S43.3.435.0306 // m-l
S43.3.435.0307 // l



black mat shiny

S43.3.435.0104 // xs-s
S43.3.435.0105 // s
S43.3.435.0106 // m-l
S43.3.435.0107 // l



brown mat shiny

S43.3.435.0204 // xs-s
S43.3.435.0205 // s
S43.3.435.0206 // m-l
S43.3.435.0207 // l



new



black

S43.3.438.0104 // xs-s
S43.3.438.0105 // s
S43.3.438.0106 // m-l
S43.3.438.0107 // l

new



mocca

S43.3.438.0204 // xs-s
S43.3.438.0205 // s
S43.3.438.0206 // m-l
S43.3.438.0207 // l

uvex elexxion plus

The innovative hybrid riding helmet combines hard-shell and inmould technology

Elegant design with a unique all-over matt look and a shiny ventilation slider

Individual adjustment in height and width

MADE IN GERMANY

Features

- Hybrid technology
- Double inmould technology
- 2 shell sizes
- 3D IAS fit system
- Monomatic fastener
- FAS Strap
- Excellent adjustable ventilation
- Changeable lining
- Slim fit lining (optional)
- Suitable for spectacle wearers
- Weight from 470 g
- Standards: EN 1384:2012 + VG1 01.040 2014-12



uvex elexxion

The innovative hybrid riding helmet combines hard-shell and inmould technology

Elegant design with a unique all-over matt look and a shiny ventilation slider

Individual adjustment in height and width

MADE IN GERMANY

Features

- Hybrid technology
- Inmould technology
- 2 shell sizes
- 3D IAS fit system
- Monomatic fastener
- FAS Strap
- Excellent adjustable ventilation
- Changeable lining
- Slim fit lining (optional)
- Suitable for spectacle wearers
- Weight from 460 g
- Standards: EN 1384:2012 + VG1 01.040 2014-12



black mat

S43.3.433.0104 // xs-s
S43.3.433.0105 // s
S43.3.433.0106 // m-l
S43.3.433.0107 // l



navy mat

S43.3.433.0304 // xs-s
S43.3.433.0305 // s
S43.3.433.0306 // m-l
S43.3.433.0307 // l



anthracite mat

S43.3.433.0404 // xs-s
S43.3.433.0405 // s
S43.3.433.0406 // m-l
S43.3.433.0407 // l



black mat

S43.3.430.0104 // xs-s
S43.3.430.0105 // s
S43.3.430.0106 // m-l
S43.3.430.0107 // l



blue mat

S43.3.430.0304 // xs-s
S43.3.430.0305 // s
S43.3.430.0306 // m-l
S43.3.430.0307 // l

uvex exxential II LED new

31 integrated LEDs in blue and red ensure maximum visibility and safety

spoga horse TOP INNOVATIONS winner 2021

Magnetic battery system with a runtime of up to 12 hours

Meets riding and cycling helmet standards

MADE IN GERMANY



Features

- 31 integrated LEDs
- IP44 standard (waterproof)
- 6–12 hours of battery life
- Inmould technology
- 2 shell sizes
- 3D IAS fit system
- Monomatic fastener
- FAS fit system
- Excellent ventilation
- Suitable for spectacle wearers
- Weight from 450 g
- Standards: EN 1384:2012 + VG1 01.040 2014-12, EN 1078

uvex exxential II MIPS new

Light all-round helmet with an excellent fit and a height-adjustable MIPS system

Extremely good price-performance ratio

Individual adjustment in height and width

MADE IN GERMANY



Features

- MIPS (height-adjustable)
- Inmould technology
- 2 shell sizes
- 3D IAS fit system
- Monomatic fastener
- FAS fit system
- Excellent ventilation
- Suitable for spectacle wearers
- Weight from 430 g
- Standards: EN 1384:2012 + VG1 01.040 2014-12



new



anthracite mat

- S43.3.427.0404 // xxs-s
- S43.3.427.0405 // s-m
- S43.3.427.0406 // m-l
- S43.3.427.0407 // l-xl



new



black mat

- S43.3.428.0104 // xxs-s
- S43.3.428.0105 // s-m
- S43.3.428.0106 // m-l
- S43.3.428.0107 // l-xl

uvex exxential II glamour

Light all-round helmet with an excellent fit

Elegant edition with a subtle crystal design

Individual adjustment in height and width

MADE IN GERMANY

Features

- Inmould technology
- 2 shell sizes
- 3D IAS fit system
- Monomatic fastener
- FAS fit system
- Excellent ventilation
- Suitable for spectacle wearers
- Grid with glitter crystals
- Weight from 420 g
- Standards: EN 1384:2012 + VG1 01.040 2014-12



black mat

S43.3.424.0104 // xxs-s
S43.3.424.0105 // s-m
S43.3.424.0106 // m-l



anthracite mat

S43.3.424.0404 // xxs-s
S43.3.424.0405 // s-m
S43.3.424.0406 // m-l



Helmet **uvex exxential II glamour**
Gloves **uvex ceravent**

uvex exxential II

Light allround helmet with an excellent fit

Extremely good price-performance ratio

Individual adjustment in height and width

Ventilation grille color-coordinated with helmet color

MADE IN GERMANY

Features

- Inmould technology
- 2 shell sizes
- 3D IAS fit system
- Monomatic fastener
- FAS fit system
- Excellent ventilation
- Suitable for spectacle wearers
- Weight from 420 g
- Standards: EN 1384:2012 + VG1 01.040 2014-12



uvex onyx glamour

Uncompromising safety at a family-friendly price

Eye-catching heart decoration with inlaid rhinestones

Outstanding fit and individual adjustment in height and width

MADE IN GERMANY

Features

- Inmould technology
- 1 shell size
- 3D IAS fit system
- Stickers with sparkling crystals
- Monomatic fastener
- FAS fit system
- Excellent ventilation
- Suitable for spectacle wearers
- Weight from 290 g
- Standards: EN 1384:2012 + VG1 01.040 2014-12



black mat

S43.3.420.0104 // xxs-s
S43.3.420.0105 // s-m
S43.3.420.0106 // m-l
S43.3.420.0107 // l-xl



mocca

S43.3.420.0204 // xxs-s
S43.3.420.0205 // s-m
S43.3.420.0206 // m-l
S43.3.420.0207 // l-xl



blue mat

S43.3.420.0304 // xxs-s
S43.3.420.0305 // s-m
S43.3.420.0306 // m-l
S43.3.420.0307 // l-xl



anthracite mat

S43.3.420.0404 // xxs-s
S43.3.420.0405 // s-m
S43.3.420.0406 // m-l
S43.3.420.0407 // l-xl



sand mat

S43.3.420.0504 // xxs-s
S43.3.420.0505 // s-m
S43.3.420.0506 // m-l
S43.3.420.0507 // l-xl



black-pink

S43.3.463.0404 // 3xs-xs



navy-pink

S43.3.463.0504 // 3xs-xs



Helmet **uvex onyxx dekor**
Gloves **uvex sportstyle kid**

uvex onyxx dekor

The popular children's riding helmet series offers uncompromising safety at a family-friendly price

Great designs and a large selection of colors

Outstanding fit and individual adjustment in height and width

MADE IN GERMANY

Features

- Inmould technology
- 1 shell size
- 3D IAS fit system
- Monomatic fastener
- FAS fit system
- Excellent ventilation
- Suitable for spectacle wearers
- Weight from 290 g
- Standards: EN 1384:2012 + VG1 01.040 2014-12



princess berry mat
S43.3.462.0504 // 3xs-xs



princess white mat
S43.3.462.0604 // 3xs-xs



princess violet mat
S43.3.462.0704 // 3xs-xs



pony black mat
S43.3.462.0804 // 3xs-xs



pony anthracite mat
S43.3.462.0904 // 3xs-xs



friends II anthracite mat
S43.3.462.1004 // 3xs-xs



friends II pink mat
S43.3.462.1104 // 3xs-xs

■ = New colorway ■ = New model

uvex onyxx

The popular children's riding helmet series offers uncompromising safety at a family-friendly price

Can be opened with just one hand thanks to the Monomatic closure

Outstanding fit and individual adjustment in height and width

MADE IN GERMANY

Features

- Inmould technology
- 1 shell size
- 3D IAS fit system
- Monomatic fastener
- FAS fit system
- Excellent ventilation
- Suitable for spectacle wearers
- Weight from 290 g
- Standards: EN 1384:2012 + VG1 01.040 2014-12



uvex onyxx

The popular children's riding helmet series offers uncompromising safety at a family-friendly price

Featuring a striking, glossy look

Outstanding fit and individual adjustment in height and width

MADE IN GERMANY

Features

- Inmould technology
- 1 shell size
- IAS fit system
- Monomatic fastener
- FAS fit system
- Excellent ventilation
- Suitable for spectacle wearers
- Weight from 290 g
- Standards: EN 1384:2012 + VG1 01.040 2014-12



blue mat

S43.3.461.0304 // 3xs-xs



black mat

S43.3.461.0104 // 3xs-xs



black shiny

S43.3.460.0104 // 3xs-xs

uvex ceravent



Dusty trails on hot days. Rubber reins in heavy rain. Stay in control with the uvex ceravent. The innovative, moisture-control riding glove guarantees an optimum grip in all conditions, while the abrasion-resistant ceraspace™ ceramic coating offers extreme durability. The material on the fingertips also allows for easy operation of a smartphone touch screen.



features



Short, athletic style

This shorter style sports glove has a snug, comfortable cuff and can be teamed with any riding outfit.

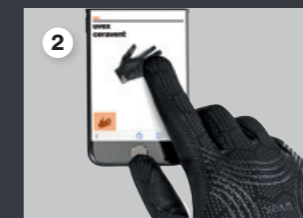

Touchscreen-sensitive

Light and grippy, but with touchscreen-sensitive capability. The pleasantly soft material on the fingertips makes the uvex ceravent a great choice for smartphone users.

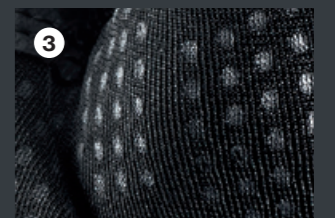

ceraspace™ coating

The functional material has a ceramic coating for extra durability.

uvex ceravent

Super-short, sporty riding glove with an ideal fit

Extreme durability and minimal abrasion thanks to the ceraspace™ coating

Optimal grip, even when wet



Features

- 4D stretch
- Abrasion resistant
- Excellent grip
- Stretch venting
- Moisture management
- Touchscreen capability
- Washable (30°C)

Material

- Backhand: ceramic-coated stretch material (80% polyamide, 20% elastane)
- Palm: 100% polyurethane composition (70% polyurethane, 30% nylon)



black

- S45.4.109.0229 // 6.5
- S45.4.109.0230 // 7
- S45.4.109.0231 // 7.5
- S45.4.109.0232 // 8
- S45.4.109.0233 // 8.5
- S45.4.109.0234 // 9
- S45.4.109.0235 // 9.5
- S45.4.109.0236 // 10
- S45.4.109.0237 // 10.5

uvex tensa II

Maximum durability and control, even under extreme conditions

Also for wet weather or arduous training

Ideal for reins or leashes

Features

- 2D stretch
- Touchscreen capability
- Washable (30°C)

Material

- Backhand: 60% polyurethane, 40% polyamide
- Palm: 70% polyurethane, 30% polyamide



light brown

- S45.4.114.0230 // 7
- S45.4.114.0231 // 7.5
- S45.4.114.0232 // 8
- S45.4.114.0233 // 8.5
- S45.4.114.0234 // 9
- S45.4.114.0235 // 9.5
- S45.4.114.0236 // 10
- S45.4.114.0237 // 10.5
- S45.4.114.0238 // 11

caramel-black

- S45.4.114.0530 // 7
- S45.4.114.0531 // 7.5
- S45.4.114.0532 // 8
- S45.4.114.0533 // 8.5
- S45.4.114.0534 // 9
- S45.4.114.0535 // 9.5
- S45.4.114.0536 // 10
- S45.4.114.0537 // 10.5
- S45.4.114.0538 // 11



Gloves uvex ceravent

uvex sportstyle diamond

Tap closure embellished with an elegant diamond design made from Swarovski® crystals: a perfect match for the uvex suxceed diamond

Eye-catcher in the dressage arena and on the course

Active moisture management and maximum comfort



Features

- 2D Stretch
- Tab closure with Swarovski® crystals
- Reinforced
- Touchscreen capability
- Washable (30°C)

Material

- Backhand/palm: 60% polyurethane, 40% polyamide



white

- S45.4.116.0228 // 6
- S45.4.116.0229 // 6.5
- S45.4.116.0230 // 7
- S45.4.116.0231 // 7.5
- S45.4.116.0232 // 8
- S45.4.116.0233 // 8.5
- S45.4.116.0234 // 9



black

- S45.4.116.0228 // 6
- S45.4.116.0229 // 6.5
- S45.4.116.0230 // 7
- S45.4.116.0231 // 7.5
- S45.4.116.0232 // 8
- S45.4.116.0233 // 8.5
- S45.4.116.0234 // 9



blue

- S45.4.116.0428 // 6
- S45.4.116.0429 // 6.5
- S45.4.116.0430 // 7
- S45.4.116.0431 // 7.5
- S45.4.116.0432 // 8
- S45.4.116.0433 // 8.5
- S45.4.116.0434 // 9

uvex sportstyle

Highly elastic glove featuring non-slip PU material

Stretch inserts on the wrist and on the hand offer a high level of comfort

Clean design, excellent durability and optimal grip

Features

- 2D Stretch
- Abrasion resistant
- Excellent grip
- Touchscreen capability
- Washable (30°C)

Material

- Backhand/palm: 60% polyurethane, 40% polyamide



uvex sportstyle winter

Ideal for the cold season: Supple and breathable with a warming Thinsulate insulation and a fluffy inner lining

Durability and comfort thanks to the highly elastic, non-slip PU material

Machine-washable up to 30 degrees

Features

- 2D Stretch
- Reinforced
- Washable (30°C)

Material

- Backhand/palm: 60% polyurethane, 40% polyamide
- Thinsulate insulation (40g)
- Lining: 87% polyester, 13% elastane



black

- S45.4.106.0226 // 5
- S45.4.106.0227 // 5.5
- S45.4.106.0228 // 6
- S45.4.106.0229 // 6.5
- S45.4.106.0230 // 7
- S45.4.106.0231 // 7.5
- S45.4.106.0232 // 8
- S45.4.106.0233 // 8.5
- S45.4.106.0234 // 9
- S45.4.106.0235 // 9.5
- S45.4.106.0236 // 10
- S45.4.106.0237 // 10.5
- S45.4.106.0238 // 11



brown

- S45.4.106.0326 // 5
- S45.4.106.0327 // 5.5
- S45.4.106.0328 // 6
- S45.4.106.0329 // 6.5
- S45.4.106.0330 // 7
- S45.4.106.0331 // 7.5
- S45.4.106.0332 // 8
- S45.4.106.0333 // 8.5
- S45.4.106.0334 // 9
- S45.4.106.0335 // 9.5
- S45.4.106.0336 // 10
- S45.4.106.0337 // 10.5
- S45.4.106.0338 // 11



white

- S45.4.105.0126 // 5
- S45.4.105.0127 // 5.5
- S45.4.105.0128 // 6
- S45.4.105.0129 // 6.5
- S45.4.105.0130 // 7
- S45.4.105.0131 // 7.5
- S45.4.105.0132 // 8
- S45.4.105.0133 // 8.5
- S45.4.105.0134 // 9
- S45.4.105.0135 // 9.5
- S45.4.105.0136 // 10
- S45.4.105.0137 // 10.5
- S45.4.105.0138 // 11



black

- S45.4.105.0226 // 5
- S45.4.105.0227 // 5.5
- S45.4.105.0228 // 6
- S45.4.105.0229 // 6.5
- S45.4.105.0230 // 7
- S45.4.105.0231 // 7.5
- S45.4.105.0232 // 8
- S45.4.105.0233 // 8.5
- S45.4.105.0234 // 9
- S45.4.105.0235 // 9.5
- S45.4.105.0236 // 10
- S45.4.105.0237 // 10.5
- S45.4.105.0238 // 11



brown

- S45.4.105.0326 // 5
- S45.4.105.0327 // 5.5
- S45.4.105.0328 // 6
- S45.4.105.0329 // 6.5
- S45.4.105.0330 // 7
- S45.4.105.0331 // 7.5
- S45.4.105.0332 // 8
- S45.4.105.0333 // 8.5
- S45.4.105.0334 // 9
- S45.4.105.0335 // 9.5
- S45.4.105.0336 // 10
- S45.4.105.0337 // 10.5
- S45.4.105.0338 // 11



blue

- S45.4.105.0426 // 5
- S45.4.105.0427 // 5.5
- S45.4.105.0428 // 6
- S45.4.105.0429 // 6.5
- S45.4.105.0430 // 7
- S45.4.105.0431 // 7.5
- S45.4.105.0432 // 8
- S45.4.105.0433 // 8.5
- S45.4.105.0434 // 9
- S45.4.105.0435 // 9.5
- S45.4.105.0436 // 10
- S45.4.105.0437 // 10.5
- S45.4.105.0438 // 11



anthracite

- S45.4.105.0526 // 5
- S45.4.105.0527 // 5.5
- S45.4.105.0528 // 6
- S45.4.105.0529 // 6.5
- S45.4.105.0530 // 7
- S45.4.105.0531 // 7.5
- S45.4.105.0532 // 8
- S45.4.105.0533 // 8.5
- S45.4.105.0534 // 9
- S45.4.105.0535 // 9.5
- S45.4.105.0536 // 10
- S45.4.105.0537 // 10.5
- S45.4.105.0538 // 11

uvex sportstyle kid

Classic design in trendy colors meets high functionality

Non-slip material guarantees ideal grip on the reins

Stretch inserts promise a high level of flexibility and high wearing comfort for the child's hand

Features

- 2D Stretch
- Reinforced
- Perforated ventilation

Material

- Backhand/palm: 60% polyurethane, 40% polyamide



uvex sumair new

For a secure, flexible grip, even when wet

The eye-catching material mix ensures optimal durability

Elegant summer glove featuring a smart design with matt and glossy details

Machine-washable up to 30 degrees

Features

- 4D Stretch
- 2D Stretch
- Stretch ventilation
- Touchscreen capability
- Washable (30°C)

Material

- Backhand/palm: 70% polyurethane, 30% polyamide
- Mesh: 87% polyamide, 13% elastane



black

- S45.7.262.0224 // 4
- S45.7.262.0225 // 4.5
- S45.7.262.0226 // 5
- S45.7.262.0227 // 5.5
- S45.7.262.0228 // 6
- S45.7.262.0229 // 6.5



pink

- S45.7.262.0524 // 4
- S45.7.262.0525 // 4.5
- S45.7.262.0526 // 5
- S45.7.262.0527 // 5.5
- S45.7.262.0528 // 6
- S45.7.262.0529 // 6.5



violet

- S45.7.262.0624 // 4
- S45.7.262.0625 // 4.5
- S45.7.262.0626 // 5
- S45.7.262.0627 // 5.5
- S45.7.262.0628 // 6
- S45.7.262.0629 // 6.5



off-white

- S45.4.117.0128 // 6
- S45.4.117.0129 // 6.5
- S45.4.117.0130 // 7
- S45.4.117.0131 // 7.5
- S45.4.117.0132 // 8
- S45.4.117.0133 // 8.5
- S45.4.117.0134 // 9



black

- S45.4.117.0228 // 6
- S45.4.117.0229 // 6.5
- S45.4.117.0230 // 7
- S45.4.117.0231 // 7.5
- S45.4.117.0232 // 8
- S45.4.117.0233 // 8.5
- S45.4.117.0234 // 9
- S45.4.117.0235 // 9.5
- S45.4.117.0236 // 10
- S45.4.117.0237 // 10.5
- S45.4.117.0238 // 11



black-blue

- S45.4.117.0428 // 6
- S45.4.117.0429 // 6.5
- S45.4.117.0430 // 7
- S45.4.117.0431 // 7.5
- S45.4.117.0432 // 8
- S45.4.117.0433 // 8.5
- S45.4.117.0434 // 9
- S45.4.117.0435 // 9.5
- S45.4.117.0436 // 10
- S45.4.117.0437 // 10.5
- S45.4.117.0438 // 11



black-pink

- S45.4.117.0528 // 6
- S45.4.117.0529 // 6.5
- S45.4.117.0530 // 7
- S45.4.117.0531 // 7.5
- S45.4.117.0532 // 8
- S45.4.117.0533 // 8.5
- S45.4.117.0534 // 9



black-silver

- S45.4.117.0628 // 6
- S45.4.117.0629 // 6.5
- S45.4.117.0630 // 7
- S45.4.117.0631 // 7.5
- S45.4.117.0632 // 8
- S45.4.117.0633 // 8.5
- S45.4.117.0634 // 9
- S45.4.117.0635 // 9.5
- S45.4.117.0636 // 10
- S45.4.117.0637 // 10.5
- S45.4.117.0638 // 11



black-burgundy

- S45.4.117.0728 // 6
- S45.4.117.0729 // 6.5
- S45.4.117.0730 // 7
- S45.4.117.0731 // 7.5
- S45.4.117.0732 // 8
- S45.4.117.0733 // 8.5
- S45.4.117.0734 // 9

uvex ventraxon

Innovative 4D stretch adapts perfectly to the rider's hand

The soft-touch material is extremely flexible and at the same time both breathable and optimally climate-optimized

Machine-washable up to 30 degrees

Features

- 4D Stretch
- 2D Stretch
- Stretch ventilation
- Touchscreen capability
- Optimized for fingernails
- Washable (30°C)

Material

- Backhand/palm: 65% polyurethane, 35% polyamide
- Mesh: 87% polyamide, 13% elastane



white

S45.4.108.0126 // 5-6
S45.4.108.0128 // 6-7
S45.4.108.0130 // 7-8
S45.4.108.0132 // 8-9
S45.4.108.0134 // 9-10



black

S45.4.108.0226 // 5-6
S45.4.108.0228 // 6-7
S45.4.108.0230 // 7-8
S45.4.108.0232 // 8-9
S45.4.108.0234 // 9-10
S45.4.108.0236 // 10-11



brown

S45.4.108.0326 // 5-6
S45.4.108.0328 // 6-7
S45.4.108.0330 // 7-8
S45.4.108.0332 // 8-9
S45.4.108.0334 // 9-10
S45.4.108.0336 // 10-11



blue

S45.4.108.0426 // 5-6
S45.4.108.0428 // 6-7
S45.4.108.0430 // 7-8
S45.4.108.0432 // 8-9
S45.4.108.0434 // 9-10
S45.4.108.0436 // 10-11

uvex i-performance 2

Extremely handy, highly elastic and durable PU glove

Mesh inserts on the fingers and on the back of the hand ensure optimal ventilation and best wearing comfort

A high-quality jewelry button featuring the logo stands for the highest quality

Features

- 4D Stretch
- 2D Stretch
- Stretch ventilation
- Reinforced
- Touchscreen capability
- Washable (30°C)

Material

- Backhand/palm: 60% polyurethane, 40% polyamide
- Mesh: 87% polyamide, 13% elastane



white

S45.4.104.0128 // 6
S45.4.104.0129 // 6.5
S45.4.104.0130 // 7
S45.4.104.0131 // 7.5
S45.4.104.0132 // 8
S45.4.104.0133 // 8.5
S45.4.104.0134 // 9
S45.4.104.0135 // 9.5
S45.4.104.0136 // 10
S45.4.104.0137 // 10.5
S45.4.104.0138 // 11



black

S45.4.104.0228 // 6
S45.4.104.0229 // 6.5
S45.4.104.0230 // 7
S45.4.104.0231 // 7.5
S45.4.104.0232 // 8
S45.4.104.0233 // 8.5
S45.4.104.0234 // 9
S45.4.104.0235 // 9.5
S45.4.104.0236 // 10
S45.4.104.0237 // 10.5
S45.4.104.0238 // 11



brown

S45.4.104.0328 // 6
S45.4.104.0329 // 6.5
S45.4.104.0330 // 7
S45.4.104.0331 // 7.5
S45.4.104.0332 // 8
S45.4.104.0333 // 8.5
S45.4.104.0334 // 9
S45.4.104.0335 // 9.5
S45.4.104.0336 // 10
S45.4.104.0337 // 10.5
S45.4.104.0338 // 11



blue

S45.4.104.0428 // 6
S45.4.104.0429 // 6.5
S45.4.104.0430 // 7
S45.4.104.0431 // 7.5
S45.4.104.0432 // 8
S45.4.104.0433 // 8.5
S45.4.104.0434 // 9
S45.4.104.0435 // 9.5
S45.4.104.0436 // 10
S45.4.104.0437 // 10.5
S45.4.104.0438 // 11



anthracite

S45.4.104.1028 // 6
S45.4.104.1029 // 6.5
S45.4.104.1030 // 7
S45.4.104.1031 // 7.5
S45.4.104.1032 // 8
S45.4.104.1033 // 8.5

S45.4.104.1034 // 9
S45.4.104.1035 // 9.5
S45.4.104.1036 // 10
S45.4.104.1037 // 10.5
S45.4.104.1038 // 11

uvex crx700

All-rounder for the stormy season

High-quality, functional materials

Schoeller® Soft Shell makes the uvex crx700 the ideal companion in wind, water and cold, as well as in the stable and in the saddle

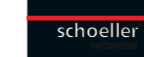

Features

- 4D Stretch
- Reinforced
- Reflective print
- Abrasion resistant
- Excellent grip
- Touchscreen capability
- Breathable
- Thermal insulation
- Moisture control
- Water repellent
- Wind repellent
- Washable (30°C)

Material

- Backhand: Soft shell (43% polyester, 36% polyamide, 13% polyurethane, 8% elastane)
- Palm: 60% polyurethane, 40% nylon
- Tricot: 100% nylon



black

S45.4.110.0228 // 6
S45.4.110.0229 // 6.5
S45.4.110.0230 // 7
S45.4.110.0231 // 7.5
S45.4.110.0232 // 8
S45.4.110.0233 // 8.5
S45.4.110.0234 // 9
S45.4.110.0235 // 9.5
S45.4.110.0236 // 10
S45.4.110.0237 // 10.5

uvex sportstyle 803 race V small new

Especially for athletes with a narrow face

Frameless, sporty design

Automatic tinting in seconds: from light to dark with uvex variomatic®

Condensation-free thanks to uvex supravision® anti-fog coating



Features

- uvex variomatic® technology
- uvex supravision® technology
- Easy to clean
- Adjustable soft nose pads
- Soft and adjustable temple ends
- Direct lens ventilation
- 100% UVA, UVB, UVC protection up to 400 nm



black

S53.2.002.2203
variomatic®
litemirror blue
(cat. 1-3)

new

grey mat-mint

S53.2.002.5505
variomatic®
litemirror silver
(cat. 1-3)

white

S53.2.002.8803
variomatic®
litemirror blue
(cat. 1-3)

uvex sportstyle 805 CV new

Unique fusion between sports and lifestyle eyewear

Full-mirror lenses

Ultimate contrast enhancement with uvex colorvision®



Features

- uvex colorvision® technology
- Adjustable soft nose pads
- Soft temple ends
- 100% UVA, UVB, UVC protection up to 400 nm

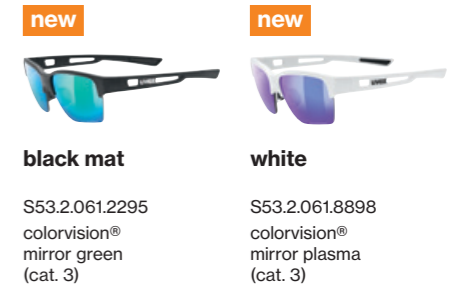

new

S53.2.061.2295
colorvision®
mirror green
(cat. 3)

new

white

S53.2.061.8898
colorvision®
mirror plasma
(cat. 3)

uvex Igl 48 CV new

Trendy design

Full-mirror lenses

Ultimate contrast enhancement with uvex colorvision®



Features

- uvex colorvision® technology
- 100% UVA, UVB, UVC protection up to 400 nm

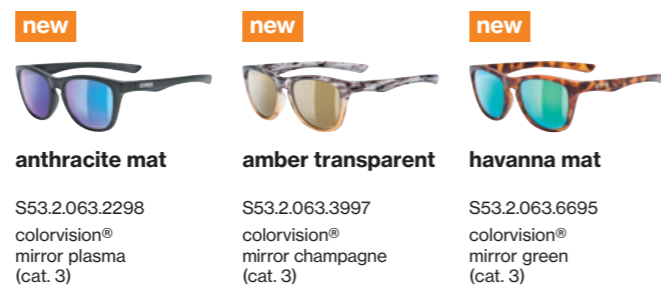

new

S53.2.063.2298
colorvision®
mirror plasma
(cat. 3)

new

amber transparent

S53.2.063.3997
colorvision®
mirror champagne
(cat. 3)

new

havanna mat

S53.2.063.6695
colorvision®
mirror green
(cat. 3)

uvex sportstyle 228 new

Progressive, oversize shield design with direct lens ventilation and XXL field of vision for sunny weather (cat. 3)

Mirrored high-tech lens

Condensation-free thanks to uvex supravision® anti-fog coating



Features

- uvex supravision® technology
- Easy to clean
- Removable frame
- Adjustable soft nose pads
- Soft and adjustable temple ends
- Direct lens ventilation
- 100% UVA, UVB, UVC protection up to 400 nm

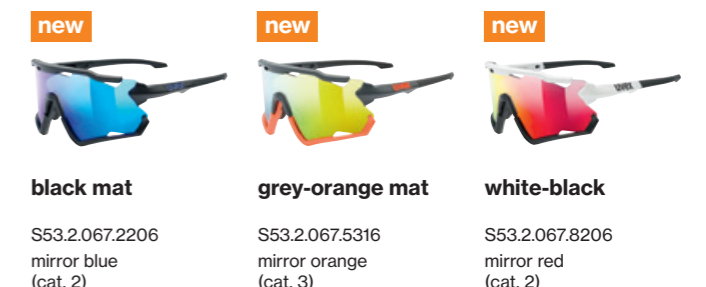

new

S53.2.067.2206
mirror blue
(cat. 2)

new

grey-orange mat

S53.2.067.5316
mirror orange
(cat. 3)

new

white-black

S53.2.067.8206
mirror red
(cat. 2)

uvex sportstyle 230 new

Mirrored allround sports glasses with a sturdy frame for sunny weather (cat. 3)

Soft nose pads and temple ends for additional comfort



Features

- Soft temple ends
- Soft nose pads
- 100% UVA, UVB, UVC protection up to 400 nm

new



black mat

S53.2.069.2216
litemirror silver
(cat. 3)

new



blue mat

S53.2.069.4416
mirror red
(cat. 3)

new



havanna mat

S53.2.069.6616
litemirror silver
(cat. 3)

uvex lgl 43 new

Lifestyle sunglasses in a timeless design with mirrored lenses in popular trendy colors

Reliable UV protection



Features

- 100% UVA, UVB, UVC protection up to 400 nm

uvex lgl 45 new

Fully-mirrored pilot sunglasses with metal frame

Reliable UV protection



Features

- 100% UVA, UVB, UVC protection up to 400 nm

new



black mat

S53.2.072.2216
mirror silver
(cat. 3)

new



gold

S53.2.072.6616
mirror gold
(cat. 3)



new



multicolor

S53.2.048.2316
mirror pink
(cat. 3)

new



blue mat

S53.2.048.4416
litemirror silver
(cat. 3)



blue havanna

S53.2.048.4616
mirror blue
(cat. 3)



havanna black

S53.2.048.6216
mirror green
(cat. 3)

uvex Igl 39 new

Lifestyle sunglasses with a classic look and mirrored lenses
Reliable UV protection



black mat red

S53.2.012.2316
litemirror brown dégradé
(cat. 3)



Features

- 100% UVA, UVB, UVC protection up to 400 nm

new



rose mat havanna

S53.2.012.3616
litemirror silver
(cat. 3)

new



red mat white

S53.2.012.3816
litemirror smoke dégradé
(cat. 3)

new



grey mat blue

S53.2.012.5416
mirror blue
(cat. 3)

new



grey mat orange

S53.2.012.5616
mirror red
(cat. 3)

uvex Igl 42 new

Lifestyle sunglasses in a timeless design with mirrored lenses and a matt-finish frame
Reliable UV protection



Features

- 100% UVA, UVB, UVC protection up to 400 nm



black transparent

S53.2.032.2916
mirror silver
(cat. 3)



blue grey mat

S53.2.032.4514
mirror blue
(cat. 3)

new



blue mat havanna

S53.2.032.4616
litemirror silver
(cat. 3)

uvex Igl 47 new

Mirrored oversize sunglasses in popular, trendy colors
Reliable UV protection



Features

- 100% UVA, UVB, UVC protection up to 400 nm

new



smoke mat

S53.2.074.5516
mirror blue
(cat. 3)

new



havanna mat

S53.2.074.6616
mirror green
(cat. 3)

new



clear

S53.2.074.9916
mirror gold
(cat. 3)

uvex sportstyle 508

Sporty and casual children's sunglasses including headband
Reliable protection for children's eyes



Features

- Eyewear strap
- 100% UVA, UVB, UVC protection up to 400 nm



black mat

S53.3.895.2216
litemirror silver
(cat. 3)



clear-pink

S53.3.895.9316
mirror red
(cat. 3)



clear-blue

S53.3.895.9416
mirror blue
(cat. 3)



clear-green

S53.3.895.9716
mirror green
(cat. 3)

accessories // merchandise

Accessories



uvex multifunctional backpack
S43.9.410.2200



uvex equestrian helmet bag
S43.9.400.2200



uvex equestrian helmet bag
S43.9.401.0100



winter cap
S43.S.141.0001 // s/m 55-58 cm
S43.S.141.0002 // l/xl 59-62 cm



uvex winter ears // uvex perfixion II
S43.9.143.0100



uvex Tocsen Button pink
S41.9.101.0200



uvex Tocsen Button black
S41.9.101.0100



uvex plug-in LED (spare part)
uvex exxential II LED
S43.9.055.0000

Merchandise



uvex eyewear floor display // 20 pcs
(lockable)
S16.W.010.0020



uvex helmets floor display // 15 pcs
(opt. helmet holder)
S16.W.040.0015



uvex multifunctional display
(opt. helmet holder, 9 glove holders incl.)
S16.W.040.2018



uvex gloves display
(18 glove holders incl.)
S16.W.040.2019



uvex eyewear slatwall display // 16 pcs
S16.W.010.6116



uvex beachflag
S16.W.403.9200 // 74 x 210 mm



uvex helmet holder
S16.W.030.0044



uvex deco head
(slatwall holder incl.)
S16.W.050.0014



Greta Busacker
Helmet uvex suxseed chrome
Gloves uvex sumair

tech summary

Helmets

Tested protection

Anyone who wears a uvex helmet travels on the side of safety. Each of our helmets undergoes rigorous tests in the uvex testing center.

Certified in accordance with

EN 1384:2012-02 + VG1 01.040 2014-12



Additionally GS tested



The voluntary test mark "GS" stands for *geprüfte Sicherheit* ("tested safety"). Find details about test criteria at: www.tuv.com

Shell materials

Outer material

PC inmould
Safety thanks to the strongly bonded PC shell.

ABS hardshell
Proven technology that has a hard shell for highly effective protection.

Inner material

EPS hardshell//inmould
Protective material made from microscopic air chambers that absorb the incident force of an impact.

Shell construction

Hardshell

The helmet has a molded outer shell and EPS inner shell for a most efficient safety combination: impact-resistant on the outside, shock-absorbing on the inside.

This complex construction allows for built-in air vents and air channels to be perfectly placed for exceptional wearing comfort.

Hybrid

Advanced technology unites the durable hard-shell construction of the upper helmet with the inmould process of the lower helmet.

Inmould

The protective EPS is foamed directly into the polycarbonate shell. For a lightweight helmet construction with the highest impact resistance and the perfect fusion of an EPS inner layer and a PC outer layer.

Fit

Shell sizes

Perfect fit = head shape + head circumference. Whether large or small, rounder or squarer: uvex has the perfect shell size, from 49 to 61 cm, for every head in its range.

uvex perfoxion II (all styles)

size	EU // cm	US // in.	UK // in.
xxs - s	52-55	6 ¹ / ₂ -6 ⁷ / ₈	6 ³ / ₈ -6 ³ / ₄
xs - s	54-55	6 ³ / ₄ -6 ⁷ / ₈	6 ⁵ / ₈ -6 ³ / ₄
s - m	55-58	6 ⁷ / ₈ -7 ¹ / ₄	6 ³ / ₄ -7 ¹ / ₈
m - l	57-59	7 ¹ / ₈ -7 ³ / ₈	7-7 ¹ / ₄
l - xl	59-61	7 ³ / ₈ -7 ⁵ / ₈	7 ¹ / ₄ -7 ¹ / ₂

uvex suxceed (all styles)

size	EU // cm	US // in.	UK // in.
xs - s	54-55	6 ³ / ₄ -6 ⁷ / ₈	6 ⁵ / ₈ -6 ³ / ₄
s	55-56	6 ⁷ / ₈ -7	6 ³ / ₄ -7 ¹ / ₈
m - l	57-59	7 ¹ / ₈ -7 ³ / ₈	7-7 ¹ / ₄

uvex onyxx (all styles)

size	EU // cm	US // in.	UK // in.
3xs - xs	49-54	6 ¹ / ₈ -6 ³ / ₄	6-6 ⁵ / ₈

uvex exxential II (all styles)

size	EU // cm	UK // in.
xxs - s	52-55	6 ³ / ₈ -6 ³ / ₄
s - m	55-57	6 ³ / ₄ -7
m - l	57-59	7-7 ¹ / ₄
l - xl	59-61	7 ¹ / ₄ -7 ¹ / ₂

uvex elexxion (all styles)

size	EU // cm	US // in.	UK // in.
xs - s	54-55	6 ³ / ₄ -6 ⁷ / ₈	6 ⁵ / ₈ -6 ³ / ₄
s	55-56	6 ⁷ / ₈ -7	6 ³ / ₄ -7 ¹ / ₈
m - l	57-59	7 ¹ / ₈ -7 ³ / ₈	7-7 ¹ / ₄
l	59	7 ³ / ₈	7 ¹ / ₄

Monomatic

The uvex monomatic comfort lock can be opened and closed with one hand.

uvex IAS

With the uvex IAS 3.0 system, helmets can be adjusted in width.

uvex 3D IAS

The uvex 3D IAS 3.0 system offers the extra feature of precise adjustment to individual head height.

FAS

Fast Adapting System straps can be easily and continuously tailored to precisely fit your head shape.

R-FAS

The Ring Fast Adapting System strap ensures extra stability and can be easily adjusted with its steel ring.

Comfort

Vent system

uvex places the highest value on optimal ventilation: cleverly designed ventilation channels draw fresh air in and expel warm air.

Removable lining

Basic pads
Removable and washable padding.

X-fit pads
High quality, structured material for improved ventilation. Removable, washable padding.

X-vent pads
High quality moisture-wicking material with embossed ventilation channels. Comfortable on the skin, quick-drying, removable and washable.

Gloves

Material

Polyurethane

- Polyurethane-coated nylon
- Durable
- Breathable
- Excellent grip
- Touchscreen compatible
- Machine washable up to 30°C

Nylon stretch

- High-stretch material for the back of the hand
- Soft and conforming
- Breathable
- Machine washable up to 30°C

Ceramic-coated

- Abrasion resistant
- Elastic
- Antipilling
- Moisture management
- Fast drying
- Machine washable up to 30°C

Fit

Glove sizes

uvex glove sizes are based on the standard French glove sizing system. Available in half sizes to ensure the perfect fit for every hand shape and size.

Half sizes

model	sizes
uvex ceravent	6.5-10.5
uvex i-performance 2	6-11
uvex sportstyle	5-11
uvex sportstyle winter	5-11
uvex sportstyle kid	4-6.5
uvex sumair	6-11
uvex tensa II	7-11
uvex sportstyle diamond	6-9
uvex crx700	6-10.5

Multifit sizes

model	sizes
uvex ventraxion	5-6
white sizes only	6-7
up to size 9-10	7-8
	8-9
	9-10
	10-11

Stretch

uvex equestrian gloves mold to the hand like a second skin. High stretch and great ventilation for the best connection between you and your horse.

2D-Stretch

An elastic strap, held in place with zigzag stitching, provides stretch in two directions.

4D-Stretch

Stretchy fabric inserts provide stretch in every direction.

Comfort

Grip

uvex uses materials with an extremely high grip surface, ensuring reins always feel secure in the hand. Whether conditions are wet or dry, the horse can be reliably led at all times.

Ventilation

Flexible fabric inserts made from lightweight stretch material, plus perforations on the fingers, allow sweat and moisture to evaporate before they have a chance to build up in the glove.

Reinforced

Double layers of material are particularly hard-wearing. Low-stress areas have a single layer of material, for maximum sensitivity.

Touchscreen-compatible

Open-pored material at the fingertips on many uvex riding gloves allow the rider to comfortably feel the reins, and making the gloves touchscreen-compatible.

Mission and responsibility

Our aspiration: "Made in uvex"

The sustainability goals of the uvex group include the following areas of responsibility: ecology, economy, working conditions and human rights, employees and society as well as product. A particular focus here is on the expansion and modernization of our production facilities. When our customers choose uvex, we want to be sure that our products meet our high quality standards. We ensure this with our principle "Made in uvex": From the product idea and development to production and sales, the entire value chain is in our hands. Carried out and supported by our own production facilities, many of them in Germany and Europe.

Now and in the future: uvex for CO₂ neutral growth

We have set ambitious goals, particularly in the area of CO₂ reductions, and we are aiming for CO₂-neutral growth in the near future. In the past four years, the uvex group has already demonstrated that this goal is not just a vision: thanks to our sustainability efforts, the company's CO₂ emissions were significantly reduced. In some plants, up to 63 % CO₂ has been saved since 2016. A development with which we want to set an example in the industry. For our future – protecting people.

protecting people



We have been producing and selling high-quality products for the protection of people in sport, leisure and work for 95 years. And if you want to protect people, you have to take responsibility. It is precisely from this mission that our obligation derives to act in a sustainable, social and socially-responsible manner.

Michael Winter
Managing Partner
of the uvex group

uvex-sports.com

UVEX SPORTS GmbH & Co. KG

Würzburger Straße 154

90766 Fürth

Postfach 25 09 · 90715 Fürth

Germany

T +49 911/97 74-0

F +49 911/97 74-4350

E sports@uvex.de

UVEX SPORTS Austria GmbH & Co. KG

Flugplatzstraße 52

5700 Zell am See

Austria

T +43 6542/533 29

F +43 6542/533 29-2412

E uvex-sports@uvex.at



facebook.com/uvexequestrian



youtube.com/uvexsport



instagram.com/uvexequestrian